

| ITEM NO. | QTY. | PART/DRAWING NO. | DESCRIPTION | MATERIAL |
|----------|------|------------------|------------------------------------|-----------|
| 1 | 1 | 73-08300-00-2 | 73 SER. 8.00 X 3.00 RIGID RIG | MISC. |
| 2 | 1 | 08309-66-12 | Ø8.00 X 3.00 85 SHORE A POLY WHEEL | MISC. |
| 3 | 1 | AX127900C | 3/4-10 X 4-15/16 SOLID AXLE ZINC | AISI 1038 |
| 4 | 1 | LN12100701 | 3/4-10 LOW HEIGHT FLEXLOC NUT | STEEL |

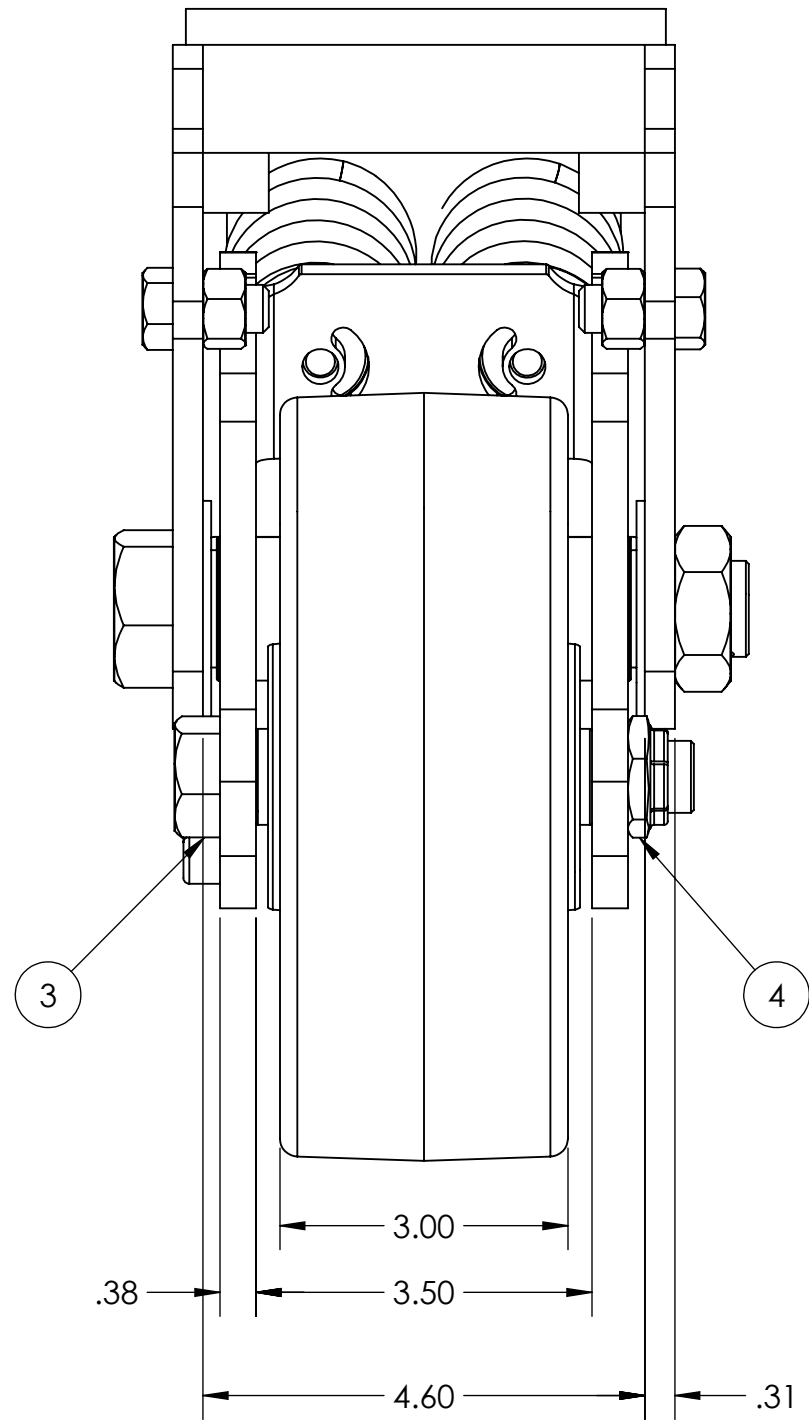
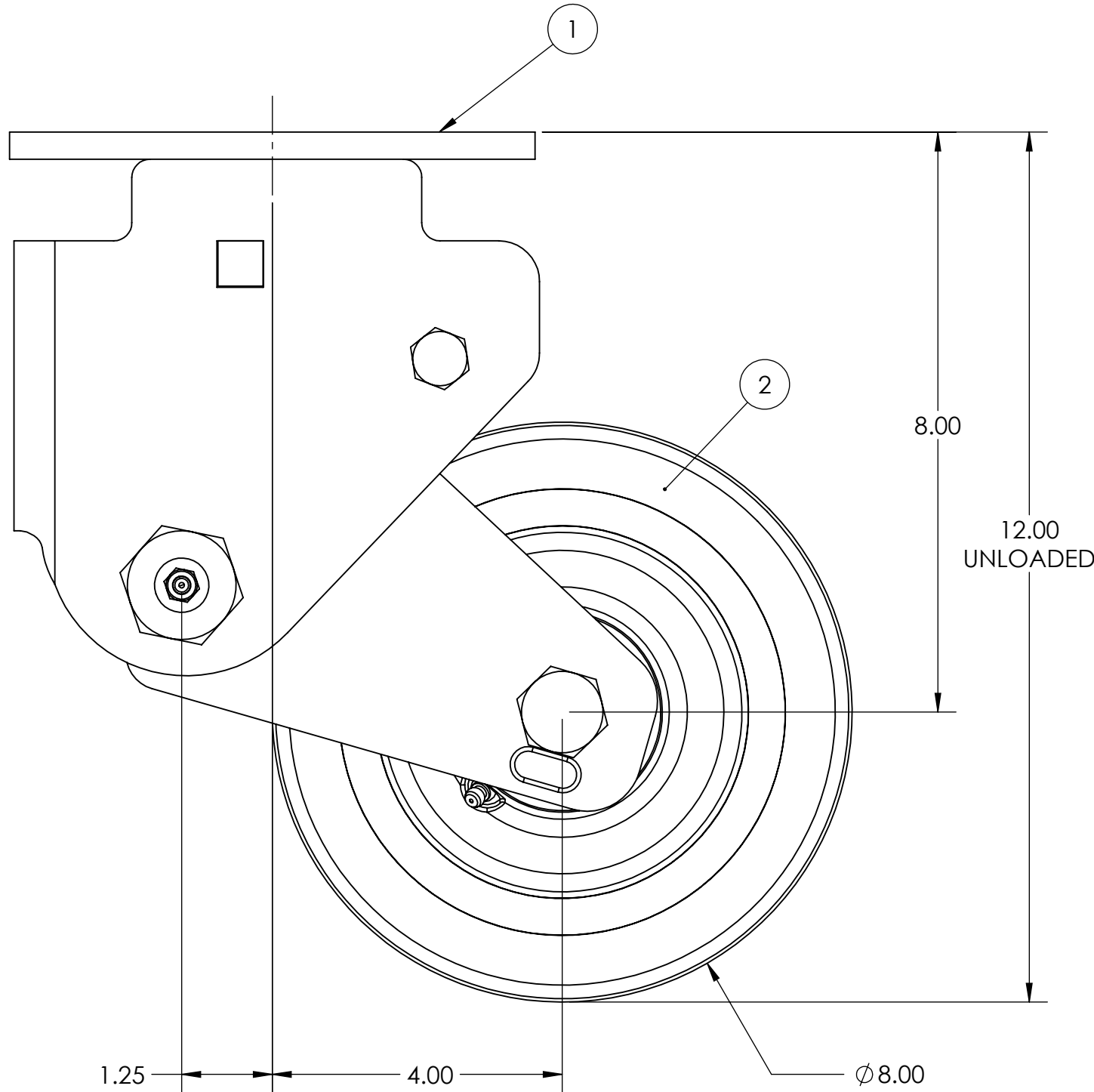
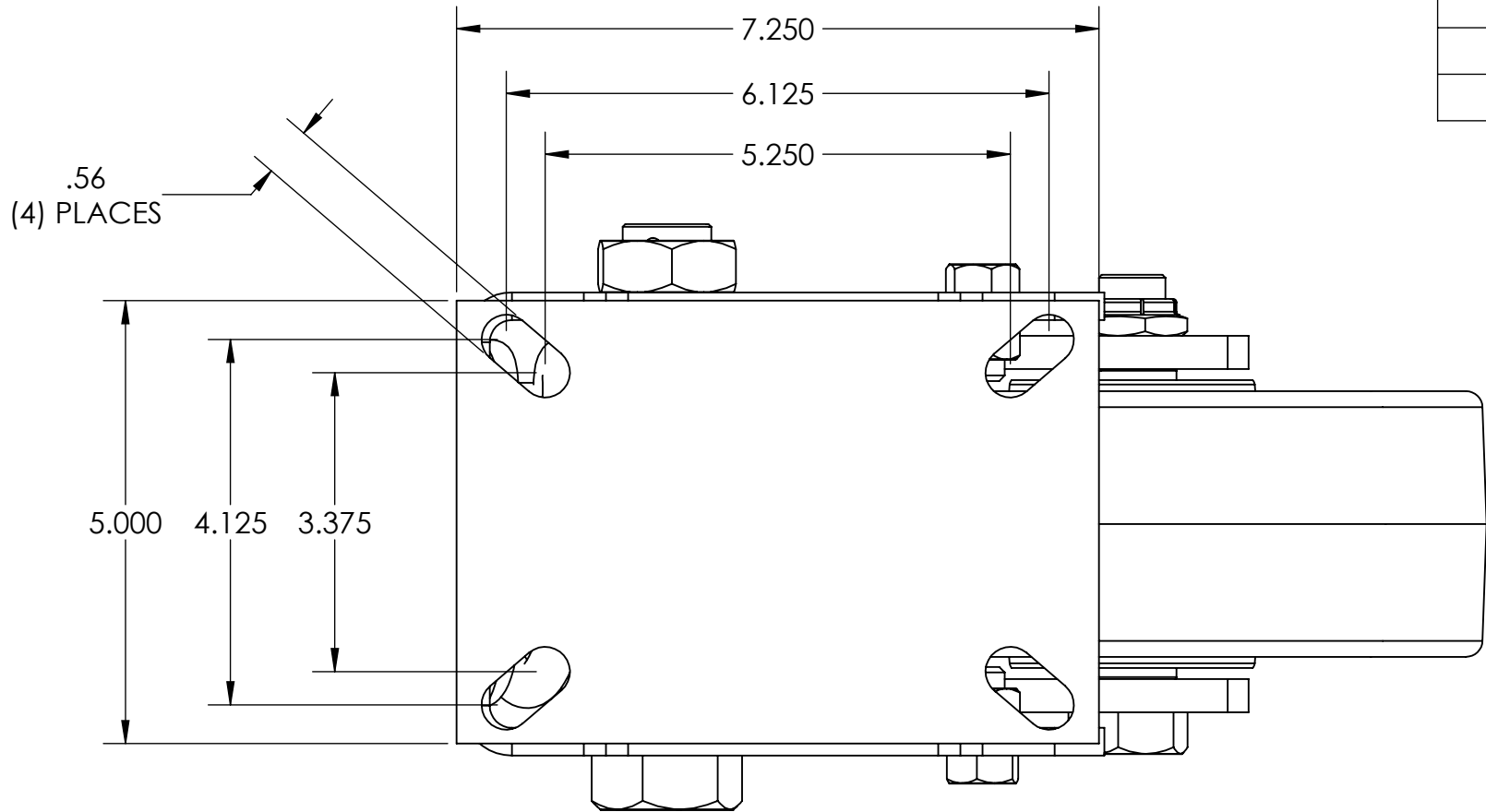
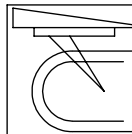

 CASTER
CONCEPTS, INC.
16000 E. MICHIGAN AVE.
ALBION, MI 49224
(517) 629-8838
casterconcepts.com

WHERE USED:
CHECKED BY: PRAVEEN K.

TOLERANCE SPECS.

FINISH SPECS.

MATERIAL SPECS.

UNLESS OTHERWISE SPECIFIED THE FOLLOWING TOLERANCES APPLY:
.XX = ±.030 .XXX = ±.010 X° = ±1.0°
PART TO BE FREE OF BURRS AND SHARP EDGES

ZINC PLATING ON RIG, GRAY PAINT ON WHEEL CORE

APPROVED BY:

DESCRIPTION: 73 SER. 8.00 X 3.00 SPRING LOADED RIGID CASTER

PART/DRAWING NO: 73-08309-66-2

DATE: 8/9/2022

SCALE: 1:4 C-SIZE

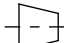
THIRD ANGLE 

NOTICE: THIS DRAWING AND DESIGN INFORMATION CONTAINED HEREIN SHALL REMAIN THE SOLE PROPERTY OF CASTER CONCEPTS INC. IT IS SUBMITTED FOR USE IN REFERENCE ONLY AND SHALL NOT BE DUPLICATED OR GIVEN TO A THIRD PARTY WITHOUT THE WRITTEN CONSENT OF CASTER CONCEPTS INC. THIS DRAWING MUST BE RETURNED TO CASTER CONCEPTS INC. UPON REQUEST AT ANY TIME. ACCEPTANCE OF THIS DRAWING SHALL BE CONSTRUED AS AN AGREEMENT OF THESE TERMS.