

# KINGPINLESS STYLE 81 SERIES



## FEATURES

**Swivel Section:** Constructed from drop forged C-1045 steel. The swivel section features a large precision machined 4" single ball bearing load/thrust raceway. The unique raceway places the 3/4" diameter load/thrust ball bearings in shear, locking the swivel section together.

**Legs:** 3/8" x 4" formed and continuously welded both inside and outside.

**Kingpin:** Kingpinless style design.

**Axle:** 1", Grade 5 axle.

**Lubrication:** Pre-lubricated before shipping.

**Wheels:** 6" to 12" diameter wheels.

**Finish:** Gold Powder Coat.

**Standard:** Shielded swivel.

## APPLICATIONS

Suitable for power drawn applications, fiberglass mold dollies, aircraft wing and spar tooling, machinery, engine and paint line dollies, body dolly carts, material carts, chassis rack carts, towed trash gondolas, aircraft maintenance stands, production line delivery trailers and automated guided vehicles.

## BENEFITS

The 81 Series kingpinless style casters feature a unique single ball race design. This design provides a high strength swivel section that will swivel easily under extremely heavy loads.

## OPTIONS

### BRAKES

Poly Lock: ..... P\*  
 Wrap Around: ..... W\*  
 Face Contact: ..... F

### SWIVEL LOCKS

Factory Installed: ..... L  
 Heavy Duty: ..... HDL  
 Heavy Duty Demountable: ..... DHDL  
 Demountable: ..... DL  
 Foot Actuated: ..... KL

SEALED SWIVEL SECTION ..... SSW

SEALED WHEELS ..... SW

TOE GUARD ..... TG

\* For wheels with a diameter > 6"

Contact the factory for special overall heights and finishes.

DUAL WHEEL DESIGN AVAILABLE

### MAXIMUM CAPACITY

# 10,000 lbs.

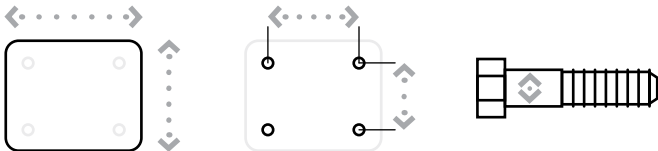

Top Plate Size	Bolt Hole Spacing	Bolt Diameter
Standard: 6.25" x 7.63"	4.5" x 6"	0.5"

### 81 SERIES TOP PLATE

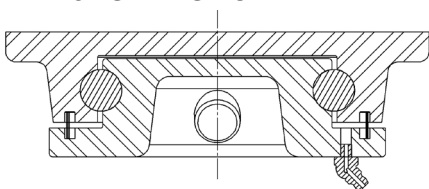

# KINGPINLESS STYLE 81 SERIES

## STRAIGHT ROLLER BEARING

Diameter	Width	Material	Capacity	OAH	Swivel Radius	Swivel Lead	Part Number	Weight
6	2.50	Forged Steel	4,000	8.50	5.64	2.50	<a href="#">81-06251-20-1</a>	38.00
6	3.00	Standard Polyurethane	2,050	8.50	5.70	2.50	<a href="#">81-06301-60-1</a>	37.00
6	3.00	H.D. Standard Polyurethane	2,500	8.50	5.70	2.50	<a href="#">81-06301-65-1</a>	40.00
6	3.00	Laminated Phenolic	2,500	8.50	5.70	2.50	<a href="#">81-06301-35-1</a>	30.00
6	3.00	Forged Steel	6,000	8.50	5.70	2.50	<a href="#">81-06301-20-1</a>	45.00
6	3.00	Cast Iron	2,500	8.50	5.70	2.50	<a href="#">81-06301-10-1</a>	36.00
6	4.00	H.D. Standard Polyurethane	3,000	8.50	5.85	2.50	<a href="#">81-06401-65-1</a>	40.00
8	3.00	Mold On Rubber	825	10.50	6.67	2.50	<a href="#">81-08301-70-1</a>	37.00
8	3.00	H.D. T/R Polyurethane	2,500	10.50	6.67	2.50	<a href="#">81-08301-66-1</a>	45.00
8	3.00	Standard Polyurethane	2,500	10.50	6.67	2.50	<a href="#">81-08301-60-1</a>	40.00
8	3.00	H.D. Standard Polyurethane	3,100	10.50	6.67	2.50	<a href="#">81-08301-65-1</a>	45.00
8	3.00	Laminated Phenolic	3,000	10.50	6.67	2.50	<a href="#">81-08301-35-1</a>	32.00
8	3.00	Forged Steel	4,500	10.50	6.67	2.50	<a href="#">81-08301-20-1</a>	44.00
8	3.00	Cast Iron	3,500	10.50	6.67	2.50	<a href="#">81-08301-11-1</a>	40.00
8	4.00	Standard Polyurethane	3,800	10.50	6.80	2.50	<a href="#">81-08401-60-1</a>	48.00
8	4.00	Forged Steel	8,400	10.50	6.80	2.50	<a href="#">81-08401-20-1</a>	48.00
10	3.00	Mold On Rubber	1,000	12.50	7.65	2.50	<a href="#">81-10301-70-1</a>	50.00
10	3.00	H.D. T/R Polyurethane	2,800	12.50	7.65	2.50	<a href="#">81-10301-66-1</a>	55.00
10	3.00	Standard Polyurethane	3,000	12.50	7.65	2.50	<a href="#">81-10301-60-1</a>	49.00
10	3.00	H.D. Standard Polyurethane	3,700	12.50	7.65	2.50	<a href="#">81-10301-65-1</a>	55.00
10	3.00	Laminated Phenolic	3,250	12.50	7.65	2.50	<a href="#">81-10301-35-1</a>	36.00
10	3.00	H.D. Forged Steel	5,000	12.50	7.65	2.50	<a href="#">81-10301-21-1</a>	54.00
10	3.00	Cast Iron	4,000	12.50	7.65	2.50	<a href="#">81-10301-11-1</a>	50.00
10	4.00	Mold On Rubber	1,500	12.50	7.76	2.50	<a href="#">81-10401-70-1</a>	51.00
10	4.00	Standard Polyurethane	4,200	12.50	7.76	2.50	<a href="#">81-10401-60-1</a>	55.00
10	4.00	H.D. Standard Polyurethane	5,000	12.50	7.76	2.50	<a href="#">81-10401-65-1</a>	60.00
10	4.00	Forged Steel	8,400	12.50	7.76	2.50	<a href="#">81-10401-20-1</a>	74.00
12	3.00	Mold On Rubber	1,125	15.50	8.63	2.50	<a href="#">81-12301-70-1</a>	55.00
12	3.00	Ductile Iron	6,500	15.50	8.63	2.50	<a href="#">81-12301-12-1</a>	70.00
12	3.00	H.D. T/R Polyurethane	2,900	15.50	8.63	2.50	<a href="#">81-12301-66-1</a>	57.00
12	3.00	H.D. Standard Polyurethane	3,850	15.50	8.63	2.50	<a href="#">81-12301-65-1</a>	53.00
12	3.00	Standard Polyurethane	3,500	15.50	8.63	2.50	<a href="#">81-12301-60-1</a>	53.00
12	4.00	Mold On Rubber	1,600	15.50	8.73	2.50	<a href="#">81-12401-70-1</a>	58.00
12	4.00	Ductile Iron	7,500	15.50	8.73	2.50	<a href="#">81-12401-12-1</a>	70.00
12	4.00	H.D. T/R Polyurethane	3,800	15.50	8.73	2.50	<a href="#">81-12401-66-1</a>	70.00
12	4.00	H.D. Standard Polyurethane	5,500	15.50	8.73	2.50	<a href="#">81-12401-65-1</a>	70.00
12	4.00	H.D. Hard Polyurethane (70D)	6,600	15.50	8.73	2.50	<a href="#">81-12401-67-1</a>	70.00

Capacity listed is for manual operation. For powered operations, consult factory.

Part Numbers listed are for the swivel casters.

For rigid casters, change series to 80 and change the last digit from 1 to 2 (i.e. 80-12409-70-2)

Estimated weight is for swivel caster. Deduct 20 percent of swivel caster weight for rigid casters.

All dimensions are in inches. All weights are in pounds.

CONTINUED

# KINGPINLESS STYLE 81 SERIES

## PRECISION TAPERED BEARING

Diameter	Width	Material	Capacity	OAH	Swivel Radius	Swivel Lead	Part Number	Weight
6	2.50	Forged Steel	5,000	8.50	5.64	2.50	<a href="#">81-06259-20-1</a>	38.00
6	3.00	H.D. T/R Polyurethane	1,640	8.50	5.70	2.50	<a href="#">81-06309-66-1</a>	37.00
6	3.00	Standard Polyurethane	2,050	8.50	5.70	2.50	<a href="#">81-06309-60-1</a>	37.00
6	3.00	H.D. Standard Polyurethane	2,500	8.50	5.70	2.50	<a href="#">81-06309-65-1</a>	40.00
6	3.00	Laminated Phenolic	2,500	8.50	5.70	2.50	<a href="#">81-06309-35-1</a>	30.00
6	3.00	Forged Steel	10,000	8.50	5.70	2.50	<a href="#">81-06309-20-1</a>	45.00
6	3.00	Cast Iron	9,000	8.50	5.70	2.50	<a href="#">81-06309-10-1</a>	36.00
6	4.00	H.D. Standard Polyurethane	3,000	8.50	5.85	2.50	<a href="#">81-06409-65-1</a>	40.00
8	3.00	Mold On Rubber	825	10.50	6.67	2.50	<a href="#">81-08309-70-1</a>	37.00
8	3.00	H.D. T/R Polyurethane	2,500	10.50	6.67	2.50	<a href="#">81-08309-66-1</a>	45.00
8	3.00	Standard Polyurethane	2,500	10.50	6.67	2.50	<a href="#">81-08309-60-1</a>	40.00
8	3.00	H.D. Standard Polyurethane	3,100	10.50	6.67	2.50	<a href="#">81-08309-65-1</a>	45.00
8	3.00	Laminated Phenolic	3,000	10.50	6.67	2.50	<a href="#">81-08309-35-1</a>	32.00
8	3.00	Forged Steel	10,000	10.50	6.67	2.50	<a href="#">81-08309-20-1</a>	44.00
8	3.00	Cast Iron	3,500	10.50	6.67	2.50	<a href="#">81-08309-11-1</a>	40.00
8	4.00	Standard Polyurethane	3,800	10.50	6.80	2.50	<a href="#">81-08409-60-1</a>	48.00
8	4.00	Forged Steel	8,400	10.50	6.80	2.50	<a href="#">81-08409-20-1</a>	48.00
10	3.00	Mold On Rubber	1,000	12.50	7.65	2.50	<a href="#">81-10309-70-1</a>	50.00
10	3.00	H.D. T/R Polyurethane	2,800	12.50	7.65	2.50	<a href="#">81-10309-66-1</a>	55.00
10	3.00	Standard Polyurethane	3,000	12.50	7.65	2.50	<a href="#">81-10309-60-1</a>	49.00
10	3.00	H.D. Standard Polyurethane	3,700	12.50	7.65	2.50	<a href="#">81-10309-65-1</a>	55.00
10	3.00	Laminated Phenolic	3,250	12.50	7.65	2.50	<a href="#">81-10309-35-1</a>	36.00
10	3.00	H.D. Forged Steel	6,500	12.50	7.65	2.50	<a href="#">81-10309-21-1</a>	54.00
10	3.00	Cast Iron	4,000	12.50	7.65	2.50	<a href="#">81-10309-11-1</a>	50.00
10	4.00	Mold On Rubber	1,500	12.50	7.76	2.50	<a href="#">81-10409-70-1</a>	51.00
10	4.00	Standard Polyurethane	4,200	12.50	7.76	2.50	<a href="#">81-10409-60-1</a>	55.00
10	4.00	H.D. T/R Polyurethane	4,000	12.50	7.76	2.50	<a href="#">81-10409-66-1</a>	60.00
10	4.00	H.D. Standard Polyurethane	5,000	12.50	7.76	2.50	<a href="#">81-10409-65-1</a>	60.00
10	4.00	Forged Steel	10,000	12.50	7.76	2.50	<a href="#">81-10409-20-1</a>	74.00
12	3.00	Mold On Rubber	1,125	15.50	8.63	2.50	<a href="#">81-12309-70-1</a>	55.00
12	3.00	Ductile Iron	6,500	15.50	8.63	2.50	<a href="#">81-12309-12-1</a>	70.00
12	3.00	H.D. T/R Polyurethane	2,900	15.50	8.63	2.50	<a href="#">81-12309-66-1</a>	57.00
12	3.00	H.D. Standard Polyurethane	3,850	15.50	8.63	2.50	<a href="#">81-12309-65-1</a>	53.00
12	3.00	Standard Polyurethane	3,500	15.50	8.63	2.50	<a href="#">81-12309-60-1</a>	53.00
12	4.00	Mold On Rubber	1,600	15.50	8.73	2.50	<a href="#">81-12409-70-1</a>	58.00
12	4.00	Ductile Iron	7,500	15.50	8.73	2.50	<a href="#">81-12409-12-1</a>	70.00
12	4.00	H.D. T/R Polyurethane	3,800	15.50	8.73	2.50	<a href="#">81-12409-66-1</a>	70.00
12	4.00	H.D. Standard Polyurethane	5,500	15.50	8.73	2.50	<a href="#">81-12409-65-1</a>	70.00
12	4.00	H.D. Hard Polyurethane (70D)	6,600	15.50	8.73	2.50	<a href="#">81-12409-67-1</a>	70.00

Capacity listed is for manual operation. For powered operations, consult factory.

Part Numbers listed are for the swivel casters. For rigid casters, change series to 80 and change the last digit from 1 to 2 (i.e. 80-12409-70-2)

Estimated weight is for swivel caster. Deduct 20 percent of swivel caster weight for rigid casters.

All dimensions are in inches. All weights are in pounds.