



# SWIVEL LOCK TYPES



### Swivel Lock (L)

The swivel lock provides notches every ninety degrees for use in straight line movement of the cart. Also available in 1, 3 or 8 position.



### Heavy Duty (HDL)

The heavy duty swivel lock provides a longer, more accessible handle made from machined steel.



### Vertical Mounted (V)

The vertical mounted swivel lock is mounted out of the way, under the yoke base of the caster. Used mostly in heavy duty applications, this swivel lock provides a more secure locking feature.



### Demountable (DL)

The demountable swivel lock is a field-installed option available up to the 71 Series. Other series can be ordered with demountable swivel locks where damage to the swivel lock may occur.



### Passive (PL)

The passive swivel lock is used when full mobility of a unit is needed. The swivel lock plunger engages a detent and locks the caster for straight line movement. When side thrust is applied, the swivel unlocks providing maximum maneuverability of the unit. This swivel lock is NOT RECOMMENDED for towed applications.

## OTHER OPTIONS .... BEYOND STANDARD



Threaded Zerks



Angle Reinforced Legs



Caster With Steering Tubes

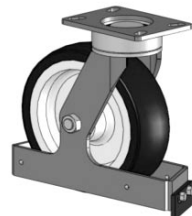

Track Brush Wiper

**CASTER CONCEPTS WILL MODIFY ANY CASTER TO MEET CUSTOMER SPECIFICATIONS**

Caster Concepts, Inc., 16000 E. Michigan Ave., Albion, MI 49224 (517) 629-8838 Facsimile (800) 800-0036 www.casterconcepts.com